

PANEL CUTOUT
MAX. PANEL THICKNESS
8.0mm [.31]

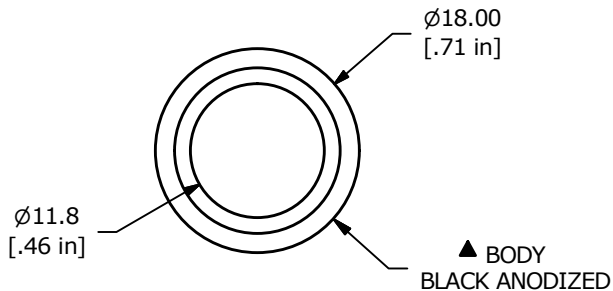

SWITCH FUNCTION	
POS. 1	POS. 2
ON	(ON)
1-3	1-2

(ON) = MOMENTARY

OBSOLETE

APRIL 2019

PCR 23619

▲ 3.4
[.134 in]

▲ HIGH SURFACE FINISH
GREEN ANODIZED

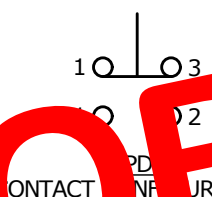

▲ 31.0±1.0
[1.22±.04 in]

2.83±0.09
[.111±.004 in]

1.50
[.06 in]

M16x1.0

3
1.80
[.071 in]

.40
[.016 in]

2.80
[.110 in]

5.60
[.220 in]

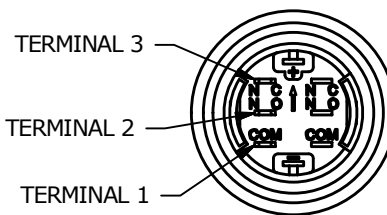

TERMINAL 3

TERMINAL 2

TERMINAL 1

- NOTE:
1. ALL DIMENSIONS IN MM [INCH]
 2. GENERAL TOLERANCE: X.X = ±0.4
X.XX = ±0.25
 3. TERMINAL NUMBERS FOR REF ONLY
 - ▲ 4. CONTACT MATERIAL: SILVER
 5. RATING: 2A 48VDC
 6. ELECTRIC LIFE: 50,000 MAKE-AND-BREAK CYCLES AT FULL LOAD.
 7. INSULATION RESISTANCE: 1,000 MΩ MIN.
 8. DIELECTRIC STRENGTH: 2,000 VAC MIN. FOR 1 MINUTE
 9. CONTACT RESISTANCE: 50mΩ MAX. @ 1A 12VDC
 10. OPERATING TEMP.: -20°C to 55°C
 11. ▲ DENOTES CRITICAL PARAMETER.
 - ▲ 12. HARDWARE SUPPLIED: O-RING AND HEXNUT
 13. INGRESS RATING: IP65
 14. 2011/65/EU (ROHS) COMPLIANT



REV	PCR NO	DESCRIPTION	DATE	BY
C	23365	UPDATED RATING TO 2A 48VDC	5/14/18	MJR
B	22888	UPDATE RATING TO 1A 24VDC	6/27/17	MJR

E-SWITCH®				
TITLE PV3SWH2B018				
SCALE	DATE	DR	DWG	REV
3:2	8/13/2012	rc	52-PV3SWH2B018	C

THE INFORMATION CONTAINED IN THIS DOCUMENT IS PROPRIETARY TO E-SWITCH AND IS NOT TO BE COPIED OR TRANSFERRED